



**glasstec**  
INTERNATIONAL TRADE FAIR FOR GLASS  
PRODUCTION • PROCESSING • PRODUCTS

NEW CHALLENGES  
**NEW CHANCES**



15-18 JUNE  
2021

Company Name:- RCMPA Polishing Technologies Pvt. Ltd.

Date of Exhibiton :- 15<sup>th</sup> to 18<sup>th</sup> June 2021. (4 Days Exhibition)

Exhibition Venue:- Fair ground Düsseldorf ,Germany

Booth Size:- 4m x 3m (Total 12sqm – 2 Side Open)

Hall – 12 (Total 9 halls as per Industry Segments)

Booth No.:- 12B10

List Products to be Displayed:- To be Finalised.

# About Glasstec 2021

- Leading international show
  - 1276 exhibitors from 50 countries and 42,600 trade visitors from 126 countries.
- Unparalleled overview of the industry
  - from manufacturing, processing and finishing through to new products and their application
- Unique ancillary programme
  - with international experts from research and practice

## **Exhibitors Profile**

Glass manufacture/ production technology

Glass processing and finishing

Glass products and applications

Solar production technology and components and pre-products for solar manufacture

Solar end products and their applications

Multifunctional facade technology

Crafts, finishing and design

Tools, spare and wear parts

Measurement and control technology

## **Visitors Profile**

Mechanical engineering

Suppliers (for example, chemical industry) / Trade.

Industry: Glass manufacturing / glass processing / glass finishing

Manufacturers of windows / facades

Glass Crafts

Architecture + building industry

**HALLEN/HALLS 9-11**

Glasprodukte und -anwendungen  
Glass products and applications

**HALLEN/HALLS 11-12, 14-17**

Glasbearbeitung und -veredelung  
Glass processing and snapping technology

**HALLE/HALL 14**

Messtechnik, Steuertechnik,  
Regeltechnik, Software  
Measurement, testing,  
control technology and software

**HALLEN/HALLS 12-16**

Glasherstellung, Produktionstechnik  
Glass production, production technology

**SONDERSCHAUEN + KONFERENZEN  
SPECIAL SHOWS + CONFERENCES**

- Halle/Hall 9 Handwerk live,  
glass art
- Halle/Hall 10 glasstec conference,  
Start-Up-Zone
- Halle/Hall 11 glass technology live  
CCD Ost Architekturkongress

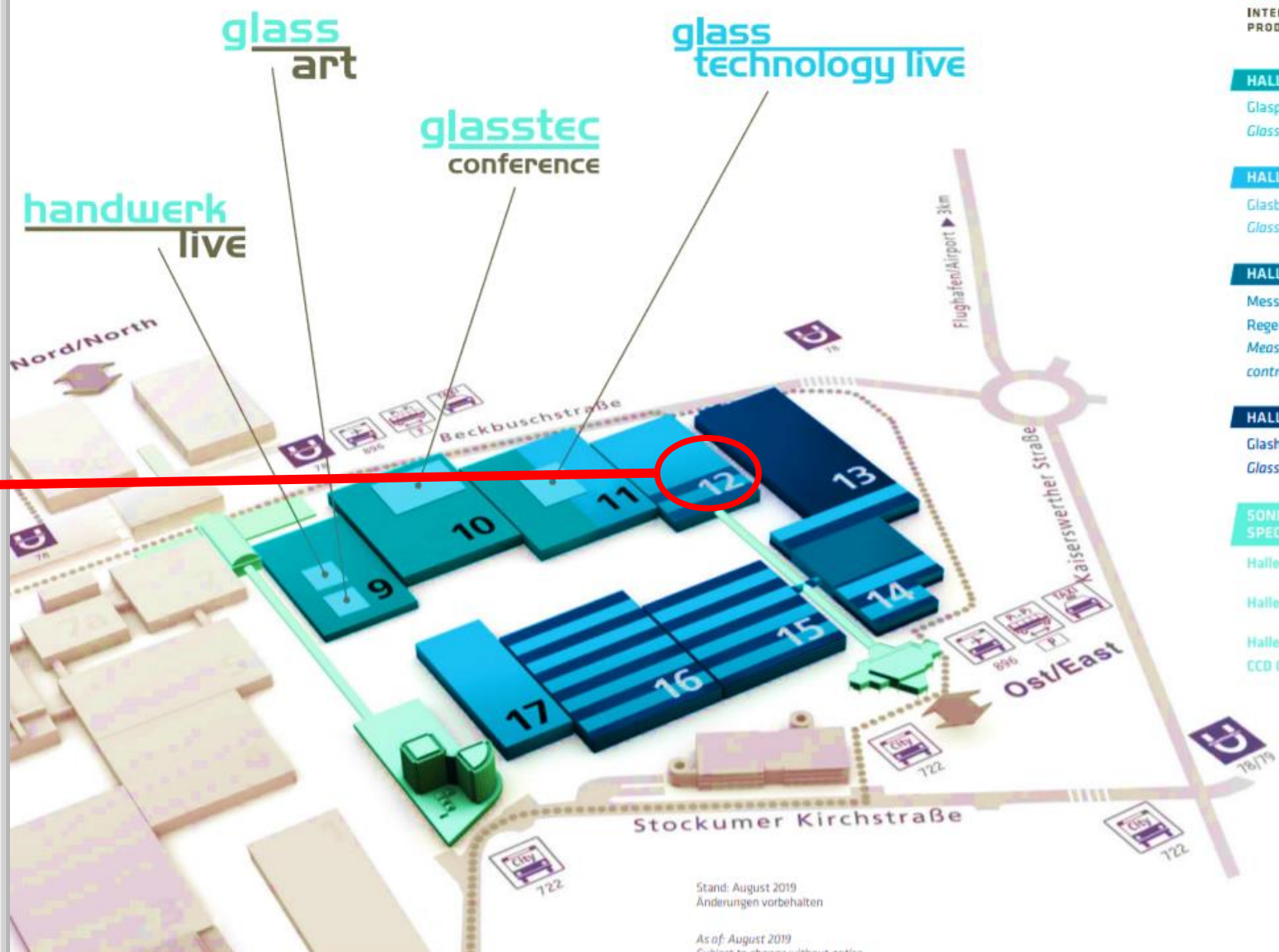

Stand: August 2019  
Änderungen vorbehalten  
As of: August 2019  
Subject to change without notice

Overall Floor Plan

Allotted Booth  
Location Hall 12

# Hall 12 Floor Plan

12 SQM. , 2 side Open, Booth 12B10,  
1. Nearer to Restaurant, Main Aisle, Nearer to Hall 12 Entrance from Hall 11, Aisle way to Hall 13

Exit from Hall 12 and entrance for Hall 13

Not so sure but look a like escalator for food court

Restaurant's

Entrance for Hall 12 from Hall 11

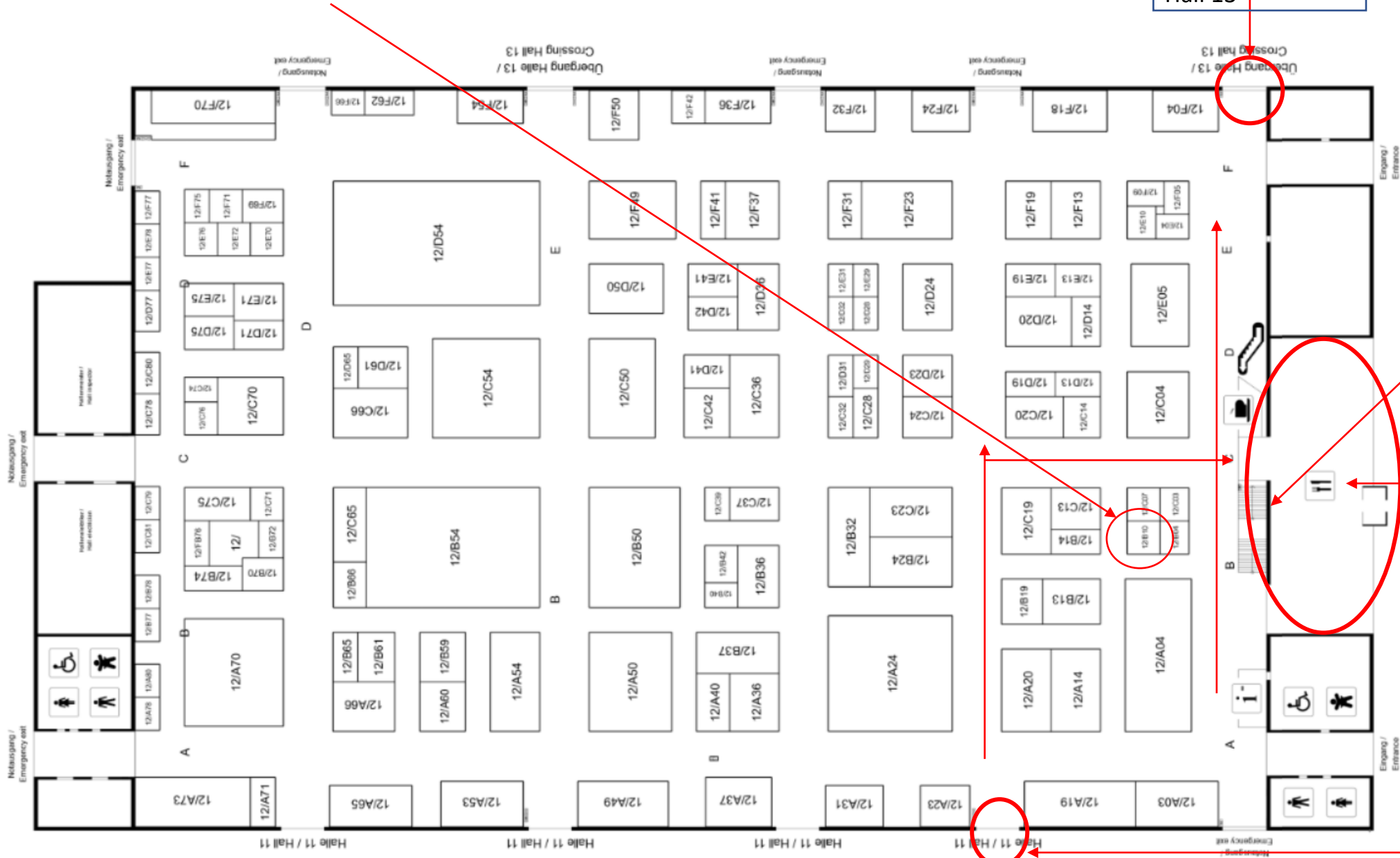

# Neighbor exhibitors

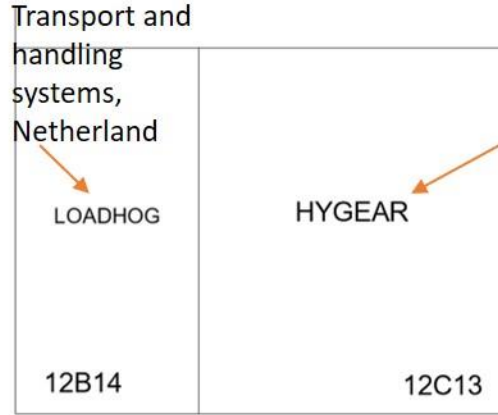
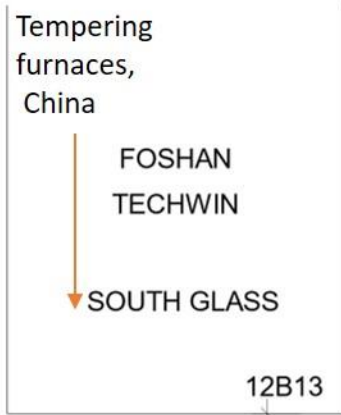

Industrial gases  
On-site hydrogen generation  
Hydrogen/Nitrogen gas recovery system

0,182,24



**Pillar**

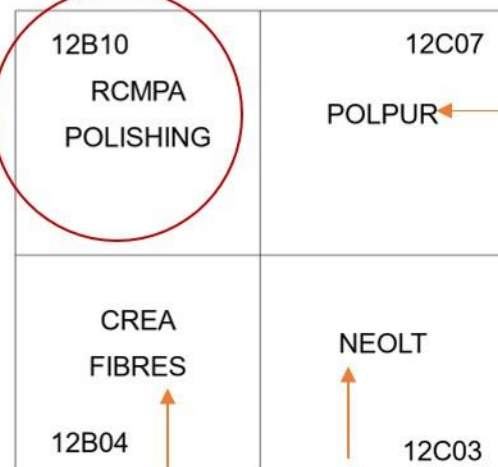

production of wide range o polishing, lapping and grinding tools, used mainly in the glass, jewelry and engineering industries. - Czech RP, Europe

Textile industry on natural, synthetic and technical products – France

3D glass technology , Singapore

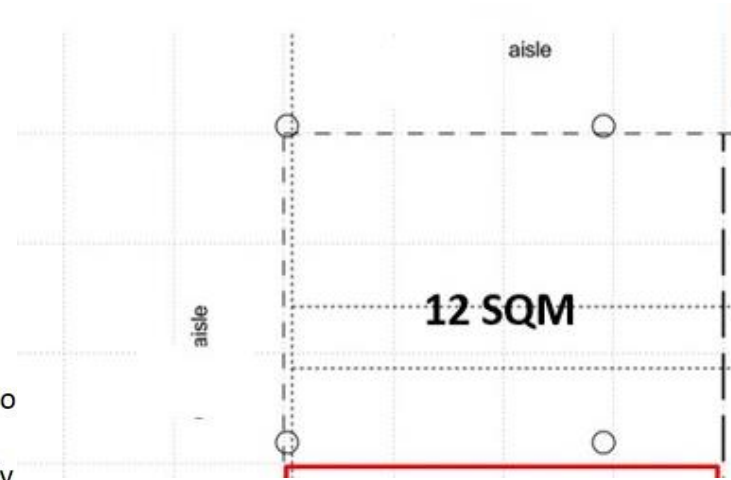

2 Side Open Booth, With Shell Scheme Package



**Details at a Glance**

- Height - 2.5 m
- Cabin Existing - No
- Electricity Inclusive - Yes
- Spotlights Inclusive - Yes
- Carpet Inclusive - Yes

**Stand system:**

- aluminum system,
- walls made of laminated fiberboard panels,
- white or light grey,
- aluminum system grid ceiling,
- back wall 250cm high,
- columns 300cm high

**Stand construction:**

- 1 fascia board per aisle
- 1 spot per 3m<sup>2</sup> stand space for illumination
- Fair-Rips carpet, color choice out of overview, included in the price

**Included material:**

Electrical package 5,2 KW  
 1x BE2202-3-phase current connections, 400 V up to 5,2 kW  
 2x BE2241-Euro power socket 230 V, 10 A, up to 2.3 kW  
 2x BE2248-Wieland coupler 230 V, 10A up to approx. 2.3 kW for exhibitor's own lighting fixtures  
 1x BE2251-earthing connection for earthing the stand, required for metal stands  
 1x BE3401-connecting the stand to the electric mains in the hall

Additional Requirement	
	45 inches LED TV with Stand to run corporate video
	2 round tables with 6 Chairs
	2 Reception Table with Company Logo Branding On it.
	Shelf or Table to Display products during exhibitions
	Multipin adopter & Spike guard

Branding Please Provide Options	Options from below
1	Portable Kit
2	Graphics
3	Theme based

Note:- We are always welcome for your inputs.

# Thank you

Mithesh Phadtare

Marketing Professional

**RCMPA Polishing Technologies Pvt.Ltd.**

**M :-** +91 74100 01652 / WhatsApp:- +91 9833206174

**E :-** marketing@rcmpa.com

**W :-** <https://rcmpa.com/>