

PLAN

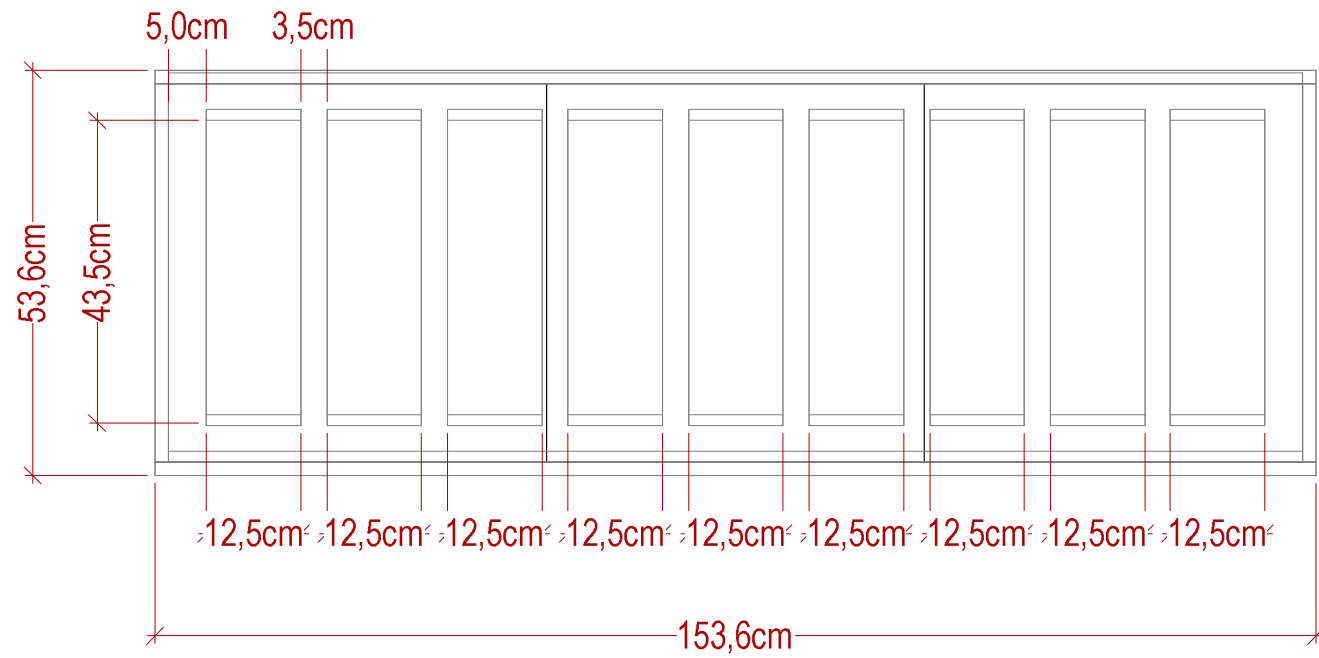

FRONT VIEW



ISOMETRIC VIEW

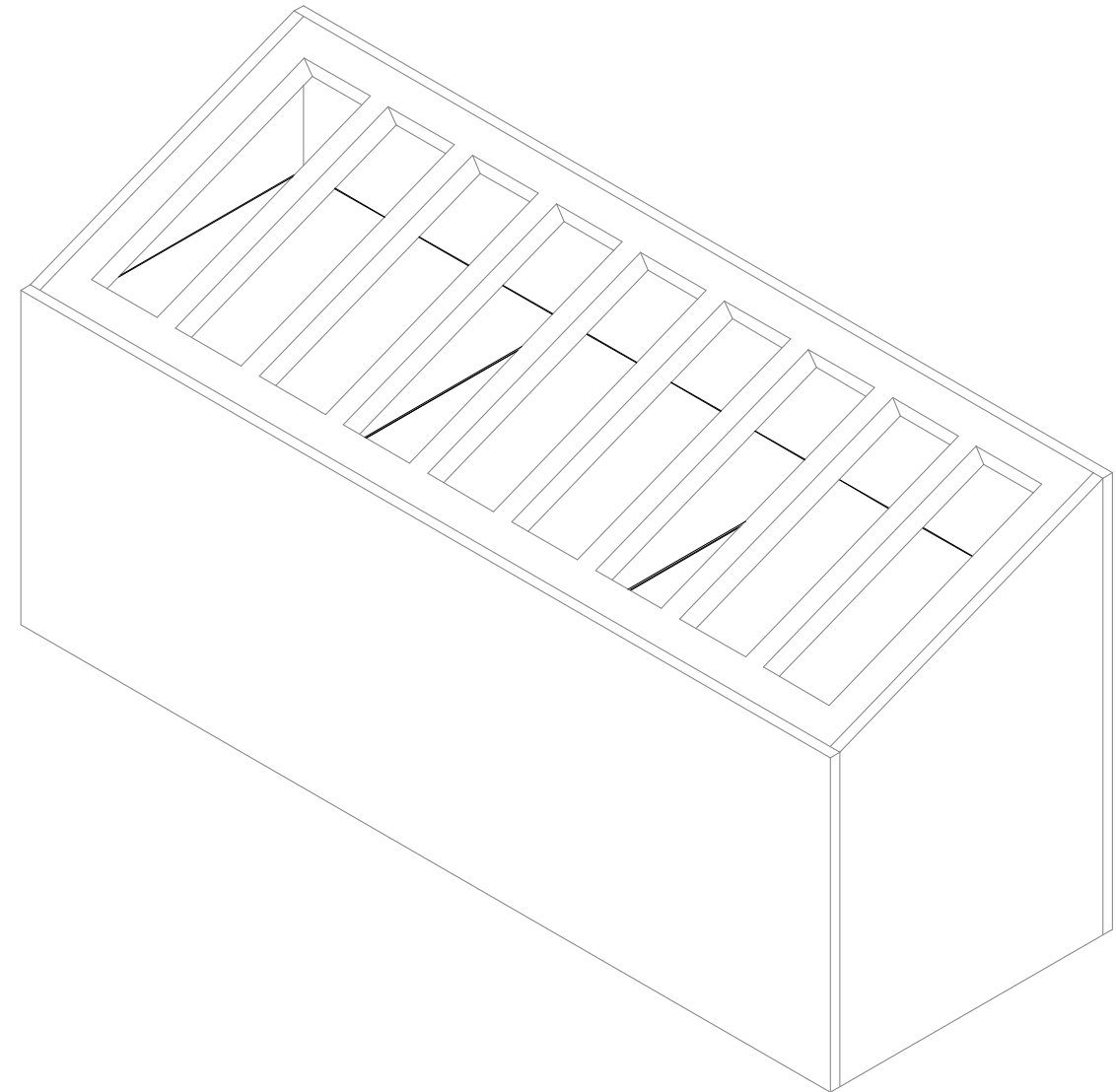

CLIENTE: SERVIS HOUSE
MANIFESTAZIONE: EICMA 2018

PADIGLIONE: 22
Stand: T16

Colorcom
exhibition solutions

Oggetto: SPECIFICA TECNICA
Data progetto: 15/10/2018

Scala: 1:10
Unità di misura: CM

Progettista: Marina Pennelli
Esecutivo: --

Tolleranza: Rif.to IO-14
Tabella tolleranze Rev. 02-17.06.11